

HOME DESIGNING SERVICE, LTD.

Date: February 2010

Feature Plan

And This Month's Special Promotion



10% Off All Stock Plans!

Present this coupons at point of purchase to receive 10% off the purchase of a stock plan valued at \$500 or more. You must present this coupon or e-mail to receive the discount.
Offer expires March 10, 2010

9198-R

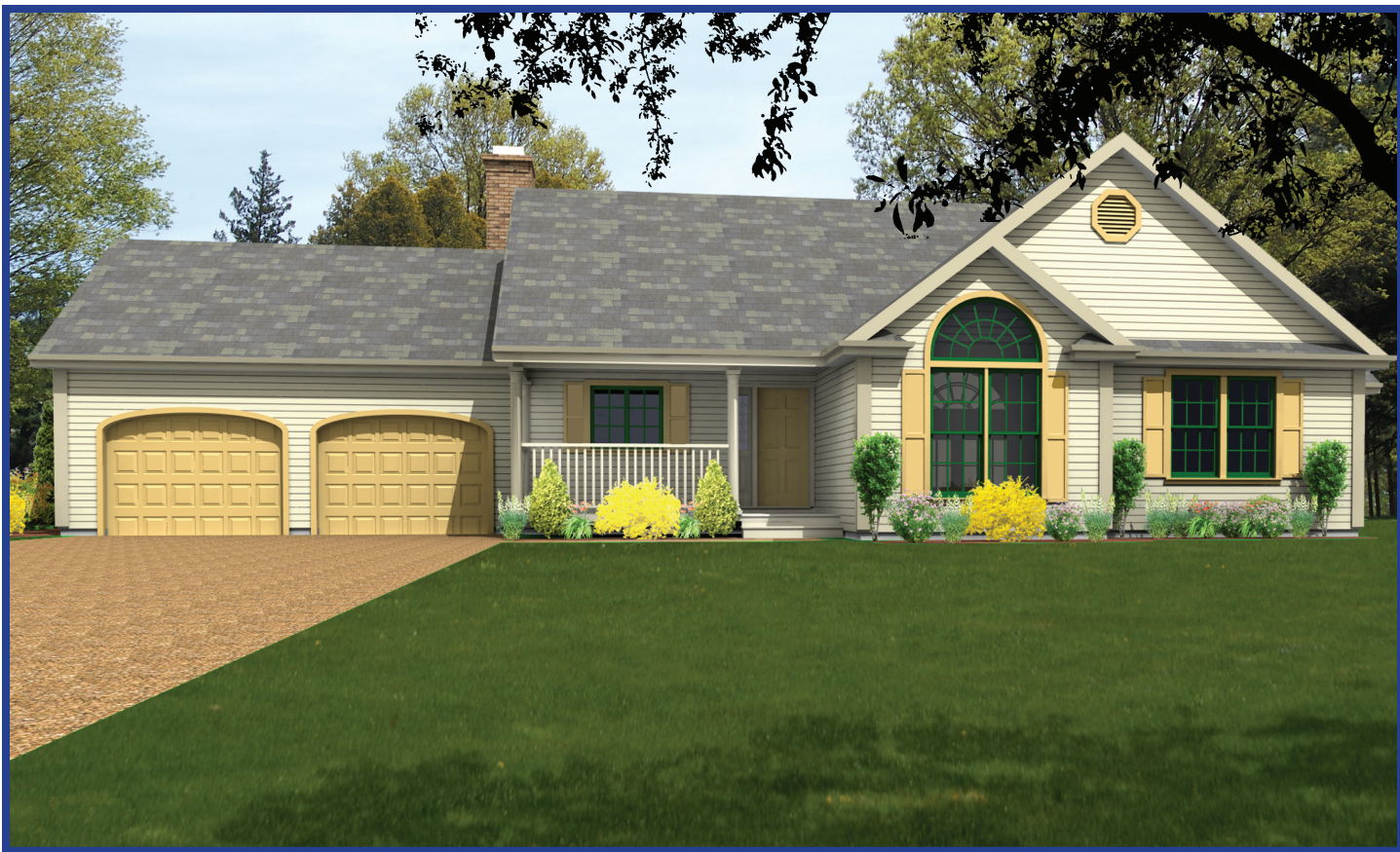
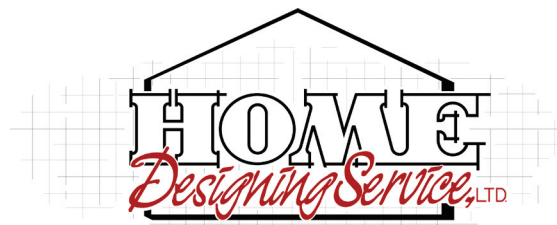

Ranch

Living Area: 1602 S.F.
Garage Area: 576 S.F.

Price:
6 sets 591.70 plus tax
Prices are subject to change without notice.

Concept through Construction...we're with you every step of the way!

Home Designing Service, Ltd has been providing homeowners, building contractors and developers with quality home plans and superior customer service since 1945. We are a multi-disciplined designing service specializing in custom home design, renovation and addition design. Our team of designers has over 120 years of design experience and their knowledge and expertise will help guide you through the entire design process and even continue to support you once construction has begun.

Services

- Stock Home Plans
- Custom Home Design
- Addition & Renovation Design
- 3D Architectural Renderings
- Kitchen & Bathroom Design
- Shed & Garage Design
- Universal (Accessible) Design
- Model Energy Code Reports
- High Wind Zone Reports

Call: 860.724.5522

Email: inquiries@homedesigningservice.com

Features of this month's plan

This plan of the month is a 1600 square foot ranch. Ranches are gaining popularity once again, especially as they traditionally offer a living area on one level. A ranch is a great layout for families or older couples looking for an accessible floor plan or a plan that can be modified in the future to meet the needs of those who want to age in place. The smaller size of these homes is more practical in the current economy and more efficient as the cost of energy continues to rise.

Ranches are often criticized for their simplicity. But a ranch doesn't have to be boring. Modern ranches can be unique and can reflect your sense of style. This month's ranch features 2 gables on the front exterior that add dimension to the front of the house and vary the roof lines. Even the windows add character, warmth and personality to an otherwise simple design.

Once inside, this ranch offers a lot of easily accessible space. The front door opens into a large foyer with convenient closet for hanging coats. The foyer opens into a large kitchen on the left and blends into the great room and dining room. The kitchen is well-appointed and highlights lots of counter space and an accessible layout. The great room offers access to a spacious sun deck. This ranch features 1 master bedroom and 2 large bedrooms. The master bedroom has a walk-in closet and large master bath, featuring a double vanity and a linen closet. The additional bedrooms share a full bathroom and both have ample closet space. The ranch is completed with a 2 car garage.

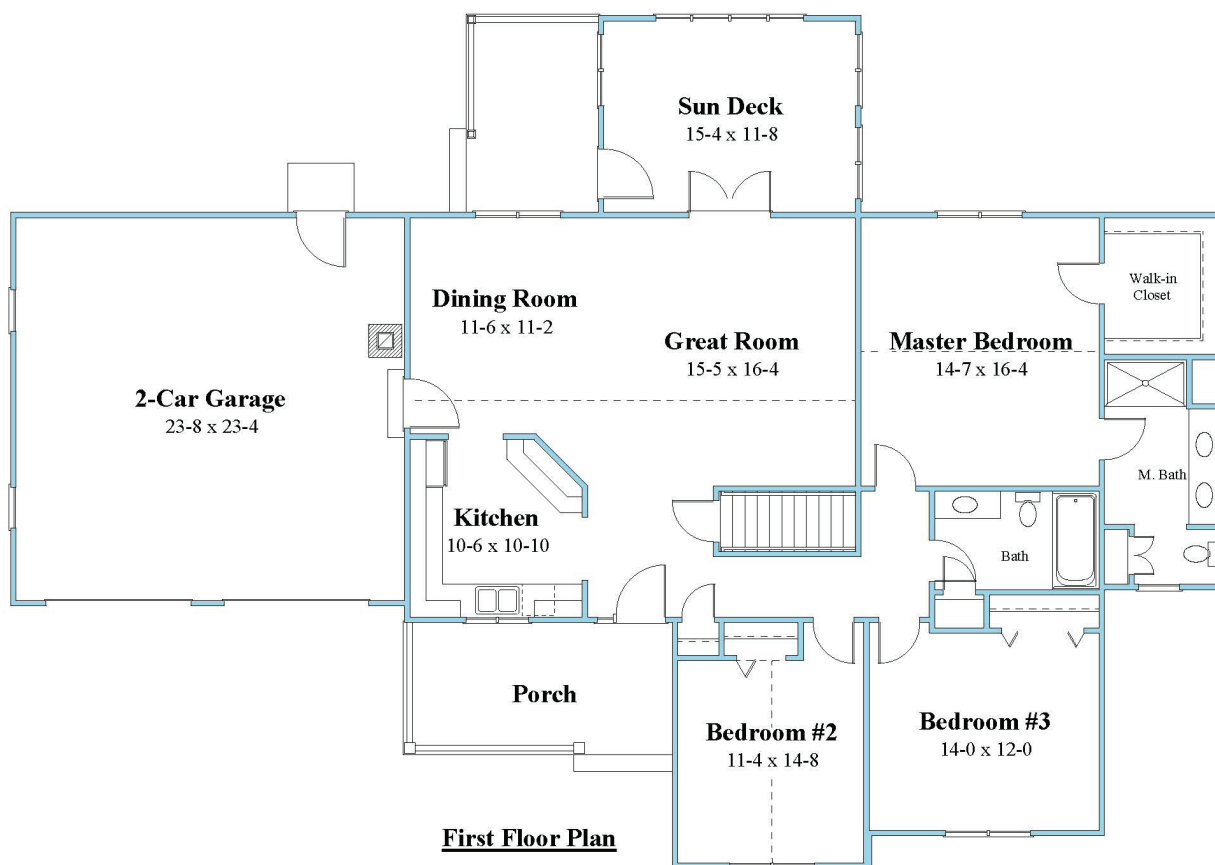

© 2010 Home Designing Service, Ltd.